

SUPERMOON

GIAMPIERO TAGLIAFERRI DESIGN

Sculptural and original forms with a distinct 1970s style give life to a design project in which elegance, formal innovation and maximum comfort coexist.

The design of the backrests and armrests, poetically evocative of a lunar phase, becomes the stylistic leitmotif of the system: their shapes, together with the seat cushions and marble or wood tops, are accommodated and partially concealed in the upholstered base that rests on the floating metal frame.

The arrangement depicted is just one example of the many different compositions possible with our seating systems.

We suggest that you contact the nearest Minotti dealer to explore the options most suited to your needs and select the upholstery of your choice from the exclusive Minotti collection.



SUPERMOON - Arrangement 02

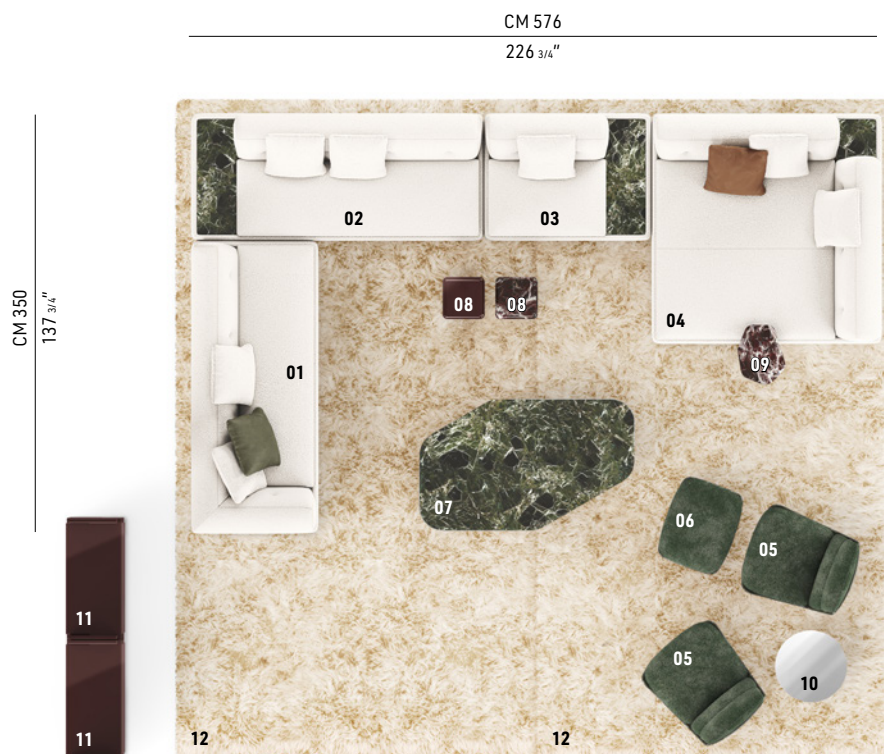

SOFA ARRANGEMENT

- 01 SUPERMOON**
ELEMENT WITH 1 ARMREST SX CM 244X106 H77
- 02 SUPERMOON**
CENTRAL ELEMENT WITH TOP MEDIUM DX
CM 244X106 H77
- 03 SUPERMOON**
ARMCHAIR / CENTRAL ELEMENT
WITH TOP MEDIUM SX CM 140X106 H77
- 04 SUPERMOON**
CHAISE-LONGUE WITH TOP SQUARE DX
CM 192X192 H77

FURNISHING ACCESSORIES

- 05 PATTIE**
ARMCHAIRS CM 78X91 H76
- 06 PATTIE**
FOOTSTOOL CM 74X59 H46
- 07 DIAGRAMMA**
COFFEE TABLE CM 180X110 H28
- 08 FILL**
SIDE TABLES CM 35X35 H43
- 09 ETHAN**
SIDE TABLE CM 50X40 H46
- 10 TOKIE**
SIDE TABLE Ø CM 60 H45
- 11 ZOE**
BOOKCASES CM 100X46 H208 - MOD. A
- 12 ALPS**
RUGS CM 550X300 - SPECIAL SIZE

Furnishing accessories



**05
PATTIE**
ARMCHAIRS CM 78X91 H76



**06
PATTIE**
FOOTSTOOL CM 74X59 H46



**07
DIAGRAMMA**
COFFEE TABLE CM 180X110 H28



**08
FILL**
SIDE TABLES CM 35X35 H43



**09
ETHAN**
SIDE TABLE CM 50X40 H46



**10
TOKIE**
SIDE TABLE Ø CM 60 H45



**11
ZOE**
BOOKCASES CM 100X46 H208 - MOD. A

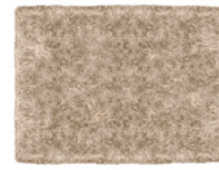

**12
ALPS**
RUGS CM 550X300
SPECIAL SIZE

Settings

